



---

## IH 6500 -- IH 6500 Interpreter Headset

---

### SAFETY PRECAUTIONS

The possible results of incorrect use are marked by one of the two symbols—"WARNING" and "CAUTION"—depending on the imminence of the danger and the severity of the damage.

	<b>WARNING:</b> Ignoring these warnings may cause severe injury or death as a result of incorrect operation.
	<b>CAUTION:</b> Ignoring these cautions may cause moderate injury or property damage as a result of incorrect operation.

### CAUTION

- Never disassemble or modify the device, as failures may result.
- Do not subject to extreme force and do not pull on the cable or failures may result.
- Keep the product dry and avoid exposure to extreme temperatures and humidity.

### WARNING

- If water or other foreign objects enter the inside of the device, fire or electric shock may result.
- Do not attempt to modify this product. Doing so could result in personal injury and/or product failure.

This device is able to produce sound volume higher than 85 dB SPL. Please check your maximum allowed continuous noise exposure level based on your national employment protection requirements.

### WARNING

**LISTENING TO AUDIO AT EXCESSIVE VOLUMES CAN CAUSE PERMANENT HEARING DAMAGE. USE AS LOW A VOLUME AS POSSIBLE.** Over exposure to excessive sound levels can damage your ears resulting in permanent noise-induced hearing loss (NIHL). Please use the following guidelines established by the Occupational Safety Health Administration (OSHA) on maximum time exposure to sound pressure levels before hearing damage occurs.

<b>90 dB SPL</b> at 8 hours	<b>95 dB SPL</b> at 4 hours	<b>100 dB SPL</b> at 2 hours	<b>105 dB SPL</b> at 1 hour
<b>110 dB SPL</b> at ½ hour	<b>115 dB SPL</b> at 15 minutes	<b>120 dB SPL</b> Avoid or damage may occur	

## IH 6500 Interpreter Headset

The IH 6500 Interpreter Headset provides exceptional audio quality, comfort, and durability for interpreters. The condenser microphone delivers natural, highly-intelligible vocal reproduction.

- Dual-sided headset designed for use with Shure DIS interpreter stations
- Supra-aural design with comfortable, lightweight construction
- Directional condenser microphone for clear, intelligible speech during important events
- Meets the European Union ISO requirement for interpreter headsets
- Flexible boom microphone pivots 270 degrees for left or right side wear and precise positioning
- Removable ear pads allow easy cleaning and are optional during use
- Terminates to two 3.5 mm connectors and includes adapter for backwards compatibility with older DIS interpreter stations
- Legendary Shure durability designed under rigorous quality standards to withstand the demands of everyday professional use

## Care and Maintenance

Clean using a soft, damp cloth.

**CAUTION:** Do not use cleansers that contain solvents. Keep liquid and foreign objects out of the driver openings.

## Wearing the Headset

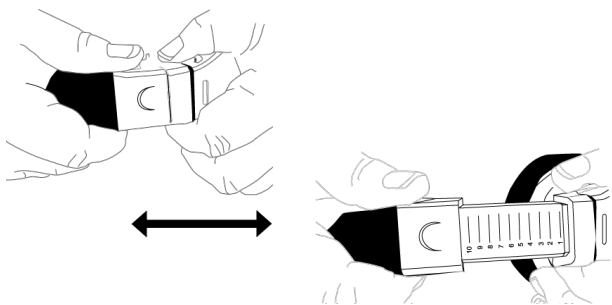

Adjust the headband for a comfortable fit.

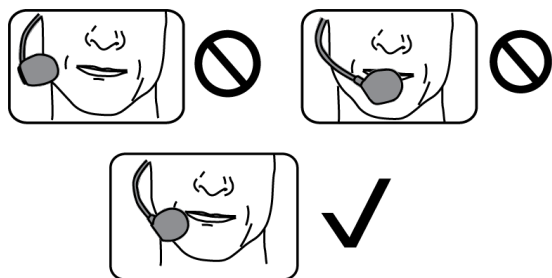

Position the boom so the microphone is within 13 mm (1/2 inch) of the corner of your mouth. To avoid "popping" or other breath noise, do not place directly in front of mouth.

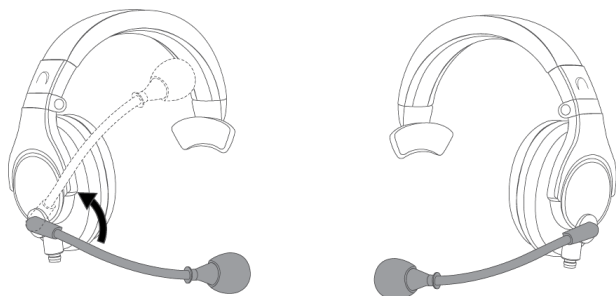

The boom swivel allows the headset to be worn on either side of your face.

## Find More Information Online

For more information, visit <http://www.shure.com>

## Replacement Parts

1 pair of replacement earcup pads for IH6500	IHAEC6500
Replacement windscreen for IH6500	IHAWS1
Cable adapter for two 1/8" (3.5 mm) female jacks to 9-pin DIN connector. Compatible with DIS legacy interpreter stations.	IHAC3.5MM-DIN
Cable adapter for two 1/8" (3.5 mm) female jacks to one 1/8" (3.5 mm) TRRS male plug	IHAC3.5MM-TRRS

## Specifications

### Weight

Net (without cable)	135 g (4.75 oz.)
Packaged	455 kg (16.0 lbs)

**Cable**

2 m, 5-conductor, 2x 3.5 mm (1/8") TRS

**Environmental Conditions**

Operating Temperature	-20° to 60° C (-4° to 140° F)
Storage Temperature	-30° to 75° C (-22° to 167° F)
Relative Humidity	45 to 85%

**Type**

Electret Condenser

**Polar Pattern**

Supercardioid

**Frequency Response**

20 to 20,000 Hz

**Output Impedance**

2,000  $\Omega$

**Sensitivity**

at 1 kHz

-48 dBV/Pa\* (4 mV)

**Polarity**

Positive pressure on diaphragm produces positive voltage on tip with respect to sleeve (ground) of microphone output phone plug connector

## Headphone

**Transducer Type**

Dynamic, Neodymium magnet

**Driver Size**

40 mm

**Frequency Response**

20 to 20,000 Hz

**Sensitivity**

@ 1 kHz

116 dB SPL/mW

**Impedance**

@ 1 kHz

120  $\Omega$

**Maximum Input Power**

200 mW

## Cable Wiring

### Dual 3.5 mm (1/8") Connectors

Connector	Color	Contact	Signal
Microphone	Pink	Sleeve	Mic -
		Tip/Ring	Mic +
Headphone	Green	Sleeve	Ground
		Tip	Headphone +
		Ring	Headphone -

# Performance Characteristics

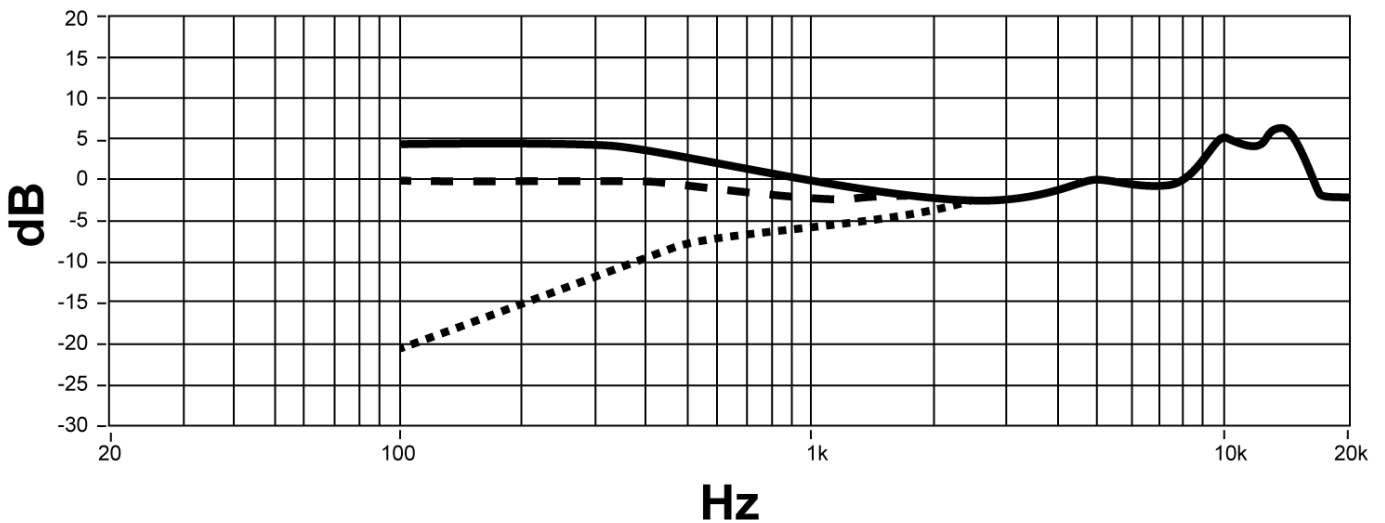
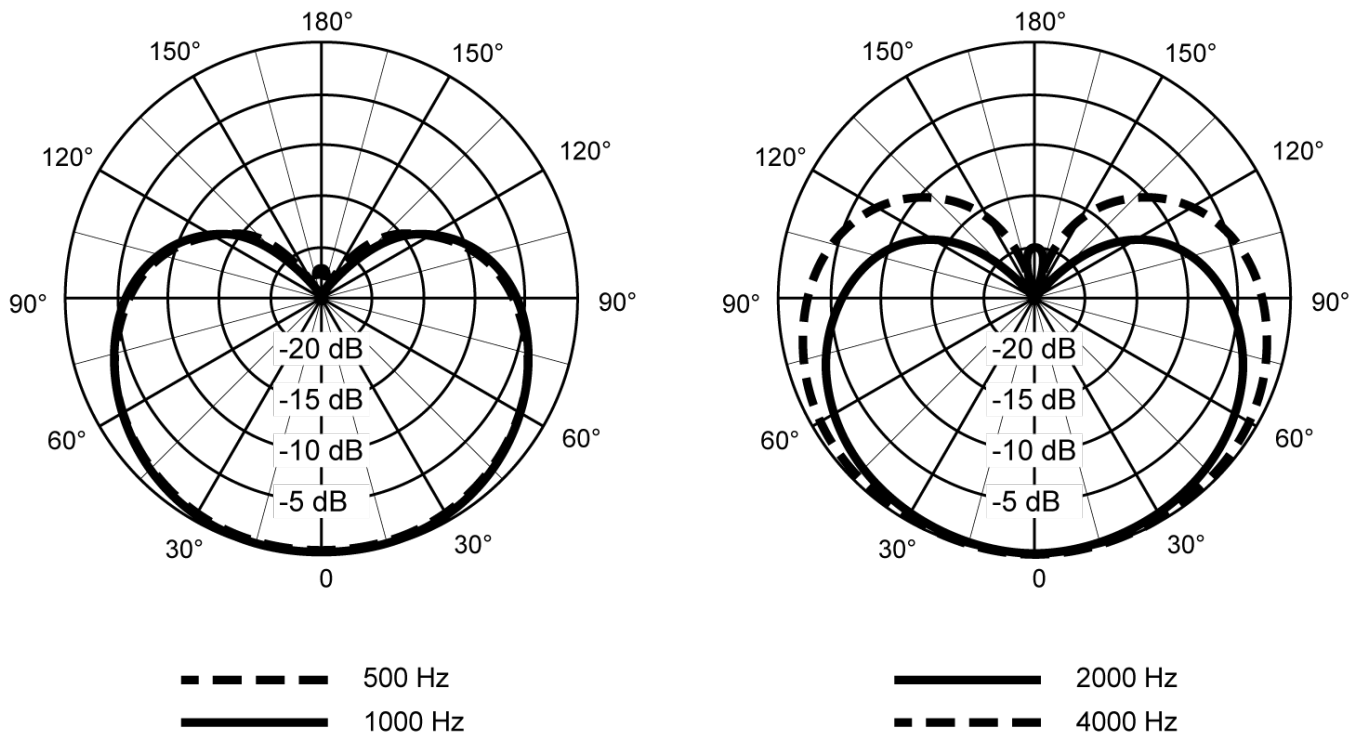

---

# Certifications

This product meets the Essential Requirements of all relevant European directives and is eligible for CE marking.

The CE Declaration of Conformity can be obtained from: [www.shure.com/europe/compliance](http://www.shure.com/europe/compliance)

Authorized European representative:

Shure Europe GmbH

Headquarters Europe, Middle East & Africa

Department: EMEA Approval

Jakob-Dieffenbacher-Str. 12

75031 Eppingen, Germany

Phone: +49-7262-92 49 0

Fax: +49-7262-92 49 11 4

Email: [info@shure.de](mailto:info@shure.de)

## LIMITED WARRANTY

Shure Incorporated ("Shure") hereby warrants to the original consumer purchaser only that, except as otherwise specified below, this product will be free in normal use of any defects in materials and workmanship for a period of two (2) years from the consumer's original date of purchase directly from Shure or from a Shure-authorized reseller.

Any rechargeable batteries contained in or packaged with this product are so warranted for a period of one (1) year from the consumer's original date of purchase. However, rechargeable batteries are consumable and their capacity will be reduced over time based on temperature, amount of time in storage, charging cycles, and other factors; hence reduction in battery capacity does not constitute a defect in material or workmanship.

At its sole option, Shure will repair or replace the defective product and promptly return it to you. In order for this warranty to be valid, the consumer must, at the time the product is returned, provide proof of purchase in the form of the original purchase receipt directly from Shure or from a Shure-authorized reseller. If Shure elects to replace the defective product, then Shure reserves the right to replace the defective product with another product of the same model or a model of at least comparable quality and features in Shure's sole determination.

If you believe this product is defective within the warranty period, carefully repack the unit, insure it and return it with proof of purchase, postage prepaid, to Shure Incorporated, Attention: Service Department, at the address below.

Outside of the United States, return the product to your dealer or Authorized Service Center. Addresses are listed on [www.Shure.com](http://www.Shure.com) or can be obtained by contacting Shure at the address listed below.

This warranty is not transferable. This warranty does not apply in cases of abuse or misuse of the product, use contrary to Shure's instruction, ordinary wear and tear, an act of God, negligent use, purchase from a party other than Shure or a Shure-authorized reseller, unauthorized repair, or modification of the product.

ALL IMPLIED WARRANTIES OF MERCHANTABILITY OR FITNESS FOR A PARTICULAR PURPOSE ARE HEREBY DISCLAIMED TO THE EXTENT PERMITTED UNDER APPLICABLE LAWS AND, TO THE EXTENT NOT PERMITTED, ARE HEREBY LIMITED TO THE DURATION AND TERMS OF THIS WARRANTY. SHURE ALSO HEREBY DISCLAIMS ALL LIABILITY FOR INCIDENTAL, SPECIAL, OR CONSEQUENTIAL DAMAGES.

Some states do not allow limitations on how long an implied warranty lasts, or the exclusion or limitation of incidental or consequential damages, so the above limitation may not apply to you. This warranty gives you specific legal rights, and you may have other rights which vary from state to state.

This warranty does not restrict the rights of the consumer mandated under applicable laws.

THIS WARRANTY SUPERSEDES ALL OTHER WARRANTIES THAT ARE ASSOCIATED OR INCLUDED WITH THIS PRODUCT, EXCEPT THAT ANY SOFTWARE CONTAINED IN OR PACKAGED WITH THIS PRODUCT IS EXCLUDED FROM THIS WARRANTY AND INSTEAD SHALL BE COVERED BY THE WARRANTY, IF ANY, PROVIDED IN SHURE'S END USER LICENSE AGREEMENT ACCOMPANYING SUCH SOFTWARE.

### Service Centers

#### **United States, Canada, Latin America, Caribbean**

Shure Incorporated

Attn: Service Department

945 Chaddick Dr.

Wheeling, IL 60090-6449 U.S.A.

#### **Europe, Middle East, and Africa**

Shure Europe GmbH

Attn: Service

Jakob-Dieffenbacher-Str. 12,

75031 Eppingen, Germany

#### **Indonesia Service Center Resmi:**

Jakarta Hotline (021) 612 6388

Medan (061) 6612550

Surabaya (031) 5032219

Jogjakarta (0274) 371710

Denpasar (0361) 766788

Makasar (0411) 324652