



This symbol indicates that dangerous voltage constituting a risk of electric shock is present within this unit.



This symbol indicates that there are important operating and maintenance instructions in the literature accompanying this unit.

### IMPORTANT SAFETY INSTRUCTIONS

1. READ these instructions.
2. KEEP these instructions.
3. HEED all warnings.
4. FOLLOW all instructions.
5. DO NOT use this apparatus near water.
6. CLEAN ONLY with dry cloth.
7. ONLY USE KSE earphones with KSA amplifiers.
8. UNPLUG this apparatus during lightning storms or when unused for long periods of time.
9. PROTECT the power cord from being walked on or pinched, particularly at plugs, convenience receptacles, and the point where they exit from the apparatus.
10. ONLY USE attachments/accessories specified by the manufacturer.
11. REFER all servicing to qualified service personnel. Servicing is required when the apparatus has been damaged in any way, such as power supply cord or plug is damaged, liquid has been spilled or objects have fallen into the apparatus, the apparatus has been exposed to rain or moisture, does not operate normally, or has been dropped.
12. DO NOT expose the apparatus to dripping and splashing. DO NOT put objects filled with liquids, such as vases, on the apparatus.
13. The MAINS plug or an appliance coupler shall remain readily operable.
14. To reduce the risk of fire or electric shock, do not expose this apparatus to rain or moisture.
15. Do not attempt to modify this product. Doing so could result in personal injury and/or product failure.
16. Operate this product within its specified operating temperature range.
17. PROTECT the earphone cable from being pinched or cut.
18. DO NOT use this apparatus if the earphone cable, housing, or connector is damaged.

**WARNING:** Voltages in this equipment are hazardous to life. No user-serviceable parts inside. Refer all servicing to qualified service personnel. The safety certifications do not apply when the operating voltage is changed from the factory setting.

Changes or modifications not expressly approved by Shure Incorporated could void your authority to operate this equipment.

**WARNING:** This product contains a chemical known to the State of California to cause cancer and birth defects or other reproductive harm.

### WARNING FOR ALL EARPHONES!

For safe and correct use of earphones, read this manual before use. Keep the manual and safety information in a convenient place for future reference.

#### WARNING

**LISTENING TO AUDIO AT EXCESSIVE VOLUMES CAN CAUSE PERMANENT HEARING DAMAGE. USE AS LOW A VOLUME AS POSSIBLE.**

Over exposure to excessive sound levels can damage your ears resulting in permanent noise-induced hearing loss (NIHL). Please use the following guidelines established by the Occupational Safety Health Administration (OSHA) on maximum time exposure to sound pressure levels before hearing damage occurs.

<b>90 dB SPL</b> at 8 hours	<b>95 dB SPL</b> at 4 hours	<b>100 dB SPL</b> at 2 hours	<b>105 dB SPL</b> at 1 hour
<b>110 dB SPL</b> at ½ hour	<b>115 dB SPL</b> at 15 minutes	<b>120 dB SPL</b> Avoid or damage may occur	

#### WARNING

- Do not use when a failure to hear your surroundings could be dangerous, such as while driving, or when biking, walking, or jogging where traffic is present and accidents could occur.
- Keep this product and its accessories out of reach of children. Handling or use by children may pose a risk of death or serious injury. Contains small parts and cords that may pose risk of choking or strangulation.
- Set the volume level of the audio device to a minimum, and then after connecting the earphones, adjust the volume gradually. Sudden exposure to loud noises could cause hearing damage.
- Turn up the volume control only far enough to hear properly.
- Ringing in the ears may indicate that the volume level is too high. Try lowering the volume.
- If you connect these earphones to an airplane's sound system, listen at low levels so that loud messages from the pilot do not cause discomfort.
- Have your hearing checked by an audiologist on a regular basis. If you experience wax buildup, discontinue use until a medical professional has examined your ears.
- Failure to use, clean, or maintain earphone sleeves and nozzles according to manufacturer's instructions may increase the risk of sleeves detaching from the nozzle and becoming lodged in your ear.
- Prior to inserting the earphone, always recheck the sleeve to make sure it is firmly attached to the nozzle.
- If a sleeve becomes lodged in your ear, seek skilled medical assistance to remove the sleeve. Damage to the ear may be caused by non-professionals attempting to remove the sleeve.
- Do not attempt to modify this product. Doing so could result in personal injury and/or product failure.

#### CAUTION

- Do not immerse in water, such as while taking a bath or washing your face, otherwise sound deterioration or failures may result.
- Do not use while sleeping as accidents may result.
- Use a slow twisting motion to remove the earphones. Never pull on the earphone cord.
- Stop using the earphones immediately if they are causing great discomfort, irritation, rash, discharge, or any other uncomfortable reaction.
- If you are currently receiving ear treatment, consult your physician before using this device.

**Note:** Use only with the included power supply or a Shure-approved equivalent.

#### WARNING

- Battery packs may explode or release toxic materials. Risk of fire or burns. Do not open, crush, modify, disassemble, heat above 140°F (60°C), or incinerate.
- Follow instructions from manufacturer
- Do not short circuit; may cause burns or catch fire
- Do not charge with products other than those specified in this user guide.
- Dispose of battery packs properly. Check with local vendor for proper disposal of used battery packs.

- Batteries (battery pack or batteries installed) shall not be exposed to excessive heat such as sunshine, fire or the like

**Note:** Battery replacement to be performed only by Shure authorized service personnel.

Please follow your regional recycling scheme for batteries, packaging, and electronic waste.

## Controls and Navigation

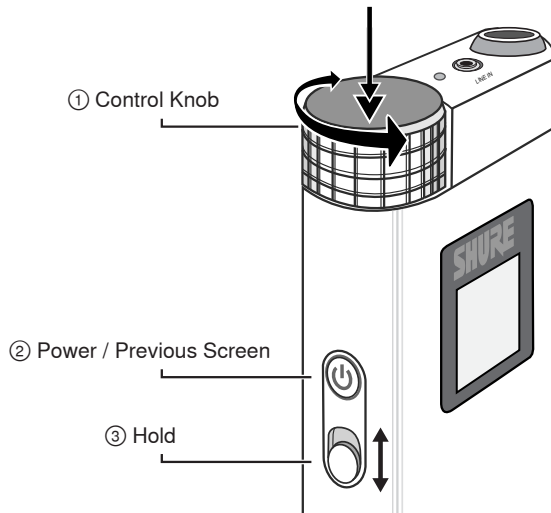

**Powering on / off:** Long press the power button ②

**Adjusting volume:** Turn the control knob ①

**Accessing the menu:** Double-click the control knob ①

**Scroll through the menu:** Turn the control knob ①

**Select an item:** Press the control knob button ①

**Return to previous screen:** Press the power button ②

**Lock / unlock the controls:** Slide the hold switch ③ to lock and unlock the power button and control knob. When switch displays red background, hold is enabled.

## Setup

### Step 1: Connect the earphones to the amplifier

Plug into the amplifier with the amplifier powered off.

**Note:** Align the earphone cable connector with the red dot towards the front of the amplifier.

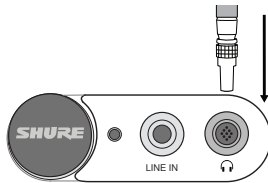

### Step 2: Connect a sound source to the amplifier.

Set the INPUT switch to LINE for analog 3.5 mm sources or USB for digital sources.

#### 3.5 mm input (analog audio)

Plug the audio device into the LINE IN input and set the INPUT switch to LINE.

To charge the battery while using an analog source, connect the amplifier to a computer or external battery

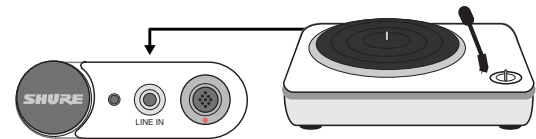

Connecting to an Analog Source

#### USB (digital audio and power)

Use the USB cable when listening to music from a computer or other USB-equipped device and set the INPUT switch to USB. When connected to a computer, USB simultaneously streams digital audio and charges the amplifier battery.

**Note:** You have the option to disable automatic charging in the Utilities menu.

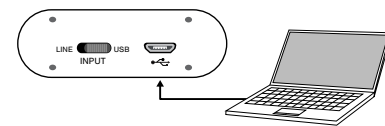

Connecting to a USB Source

### Step 3: Power on the amplifier

The driver automatically installs when the amplifier is first plugged into a device. The KSE1500 should take over as the default audio device.

**Note:** Volume controls are disabled on Windows, Mac, and iOS. Volume should be adjusted only by using the amp volume knob for best performance. Ensure that volume is maximized in iTunes or the Windows Media Player.

## Firmware

Firmware is embedded software in each component that controls functionality. Periodically, new versions of firmware are developed to incorporate additional features and enhancements. To take advantage of design improve-

ments, new versions of the firmware can be downloaded and installed using the Shure Update Utility tool.

Software is available for download from <http://www.shure.com/update-utility>.

## Using Earphones

### Safely Connect and Disconnect Earphones

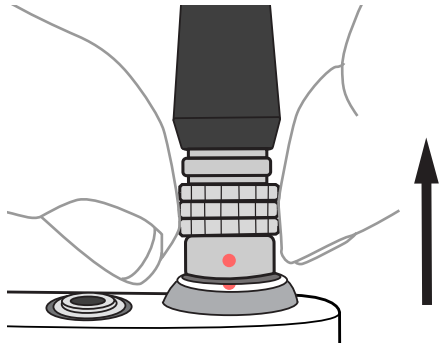

**Connect to the amplifier:** Align the red dot on the earphone cable connector with the red dot on the amplifier earphone output.

**Disconnect from the amplifier:** Pull the knurled connector collar up to safely release the lock on the earphone cable.



### Choosing a Sleeve

Select an earphone sleeve that provides the best fit and sound isolation. It should be easy to insert, fit comfortably, and easy to remove.

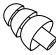
	<b>Soft Flex Sleeves:</b> In small, medium, and large sizes. Made from pliable rubber.
	<b>Soft Foam Sleeves:</b> Compress the foam sleeve between your fingers and insert into the ear canal. Hold in place for about ten seconds while the foam expands.
	<b>Triple-Flange Sleeves:</b> If desired, use scissors to trim the stem on the sleeve.

### Wearing the Earphones

- Carefully insert the earphone into the ear like an earplug, so that a tight seal is formed.

**Important:** If there is a lack of low frequency response (bass), the earphone sleeve may not be forming a proper seal. Gently push the earphone deeper into the ear canal or try using a different sleeve.

**Warning:** Do not push the earphone sleeve beyond the ear canal opening.

- Wear earphone cables over the back of the ear to keep them in place during physical activity. Guide the cable down either the front or back of the body, and use the cable cinch to tighten up the remaining slack.



The fit of the earphone can greatly affect sound quality.

### Changing Sleeves

- Twist and pull to remove the sleeve from the nozzle.
- Slide on a new sleeve so that it completely covers the barb and the nozzle.

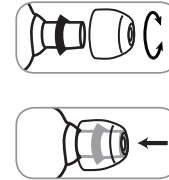

**Caution:** If the barb or any of the nozzle is exposed, the sleeve is not properly installed. Replace sleeves if they do not tightly grip the nozzle. To ensure proper fit and performance, use only sleeves supplied by Shure (unless using custom molded sleeves).

### Removing the Earphones

Grasp the body of earphone and gently twist to remove.



**Note:** Do not pull on cable to remove earphone.

### Maintenance and Cleaning

Careful maintenance ensures a tight seal between the sleeve and nozzle, improving sound quality and product safety.

- Keep the earphones and sleeves as clean and dry as possible.
- To clean sleeves, remove them from earphones, gently rinse in warm water and air dry. Foam sleeves require a longer drying time. Inspect for damage and replace if necessary. Ear sleeves must be completely dry before reusing.
- Wipe the earphones and sleeves with mild antiseptic to avoid infections. Do not use alcohol-based disinfectants.
- Do not expose earphones to extreme temperatures.
- Replace sleeves if they do not fit properly.
- Do not attempt to modify this product. Doing so will void the warranty and could result in personal injury and/or product failure.

### Cleaning the Earphone Nozzle

If you notice a change in sound quality, remove the sleeve and check the nozzle of your earphone. If nozzle is blocked, clear obstruction by using wire loop end of cleaning tool.

If no obstruction is found or if sound quality does not improve, replace the sleeve with a new sleeve.

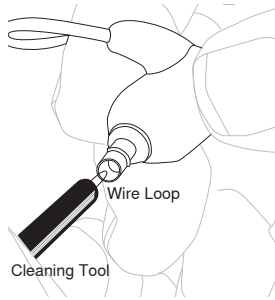

**Caution:** When cleaning, do not force any object through the earphone nozzle! This will damage the earphone sound filter.

**Warning:** The cleaning tool is only to be used to clean the earphones. Any other use, such as using the tool to clean ears or foam sleeve, could result in injury.

The cable connectors to the earphones may collect debris or other deposits that can affect audio quality. If this happens, disconnect the cables and clean them using a dry cotton swab.

## Specifications

### Kit Specifications

#### Bias Voltage

200 V DC

#### Output Voltage

$\pm 200$  V, max.

#### Output Current

$\leq 1$  mA

#### Sound Isolation

$\leq 37$  dB

#### Operating Temperature Range

-18 to 57 °C (0 to 135 °F)

### Earphone Specifications

#### Transducer Type

Electrostatic

#### Connector Type

Lemo Connector

#### Frequency Response

10 Hz to 50 kHz

#### Maximum SPL

1 kHz at 3% THD

113 dB SPL

#### Net Weight

44.0 g (1.55 oz.)

### KSA1500 Amplifier Specifications

#### Bit Depth

16-bit / 24-bit

#### Sampling Rate

44.1 / 48 / 88.2 / 96 kHz

#### Signal-to-Noise Ratio

up to 107 dB A-weighted

#### Adjustable Gain Range

-40 dB to +60 dB

#### Limiter

Selectable Analog RMS Limiter

#### Equalizer

4-band Parametric

#### USB Input

USB Micro-B Receptacle

#### Line-In Input

3.5 mm (1/8")

#### Charging Requirements

USB-powered: 5 V/0.5 A to 1 A

#### Housing

Black Anodized Aluminum

#### Net Weight

182.0 g (6.42oz.)

#### Dimensions

111 x 59 x 21 mm H x W x D

### Battery Specifications

#### Battery Type

Rechargeable Li-Ion

#### Nominal Voltage

3.6 V DC

#### Battery Life

Analog in (BYPASS EQ mode)	up to 10 hours
USB Input (EQ mode)	up to 7 hours

**Battery Charging Temperature Range**

0 to 45 °C (32 to 113 °F)

---

## Certifications

Mac<sup>®</sup> and Lightning<sup>®</sup> are registered trademarks of Apple Inc.

### Information to the user

This equipment has been tested and found to comply with the limits for a Class B digital device, pursuant to Part 15 of the FCC Rules. These limits are designed to provide reasonable protection against harmful interference in a residential installation. This equipment generates uses and can radiate radio frequency energy and, if not installed and used in accordance with the instructions, may cause harmful interference to radio communications. However, there is no guarantee that interference will not occur in a particular installation. If this equipment does cause harmful interference to radio or television reception, which can be determined by turning the equipment off and on, the user is encouraged to try to correct the interference by one or more of the following measures:

- Reorient or relocate the receiving antenna.
- Increase the separation between the equipment and the receiver.
- Connect the equipment to an outlet on a circuit different from that to which the receiver is connected.
- Consult the dealer or an experienced radio/TV technician for help.

**Industry Canada ICES-003 Compliance Label:** CAN ICES-3 (B)/NMB-3(B)

**Note:** Testing is based on the use of supplied and recommended cable types. The use of other than shielded (screened) cable types may degrade EMC performance.

This product meets the Essential Requirements of all relevant European directives and is eligible for CE marking.

The CE Declaration of Conformity can be obtained from:  
[www.shure.com/europe/compliance](http://www.shure.com/europe/compliance)

Authorized European representative:  
Shure Europe GmbH  
Headquarters Europe, Middle East & Africa  
Department: EMEA Approval  
Jakob-Dieffenbacher-Str. 12  
75031 Eppingen, Germany  
Phone: +49-7262-92 49 0  
Fax: +49-7262-92 49 11 4  
Email: [info@shure.de](mailto:info@shure.de)

### Patent Notice

U.S. patent number

- 9,210,497

### Android Compatibility

The Portable Listening Amplifier is compatible with Android devices that support USB Audio Class 2.0 and Micro-B OTG (On-The-Go) connectivity. Not all Android devices are compatible. Android is a trademark of Google Inc.

"Made for iPod," "Made for iPhone," and "Made for iPad" mean that an electronic accessory has been designed to connect specifically to iPod, iPhone, or iPad, respectively, and has been certified by the developer to meet Apple performance standards. Apple is not responsible for the operation of this device or its compliance with safety and regulatory standards. Please note that the use of this accessory with iPod, iPhone, or iPad may affect wireless performance.

iPad, iPhone, iPod, iPod classic, iPod nano, iPod touch, and Retina are trademarks of Apple Inc., registered in the U.S. and other countries. iPad Air and iPad mini are trademarks of Apple Inc. The trademark "iPhone" is used with a license from iPhone K.K.